



Harvard LuteCem SE

Self-etching and adhesive dual cure resin modified luting cement

Harvard LuteCem SE allows fast handling time – no etching and bonding required. Comfortable use in the root canal through IntraTips. Easy removal of excess material. In addition, Harvard LuteCem SE has a high fluoride release and excellent color stability.

- Suitable for two indications:
 1. Luting of posts made of Ceramics, Non precious metal, Fiber-reinforced materials
 2. Luting of crowns and bridges made of Ceramics, Zirconia, Composites and Non precious metal
- Dual cure
- Fluoride release
- Virtually no shrinkage

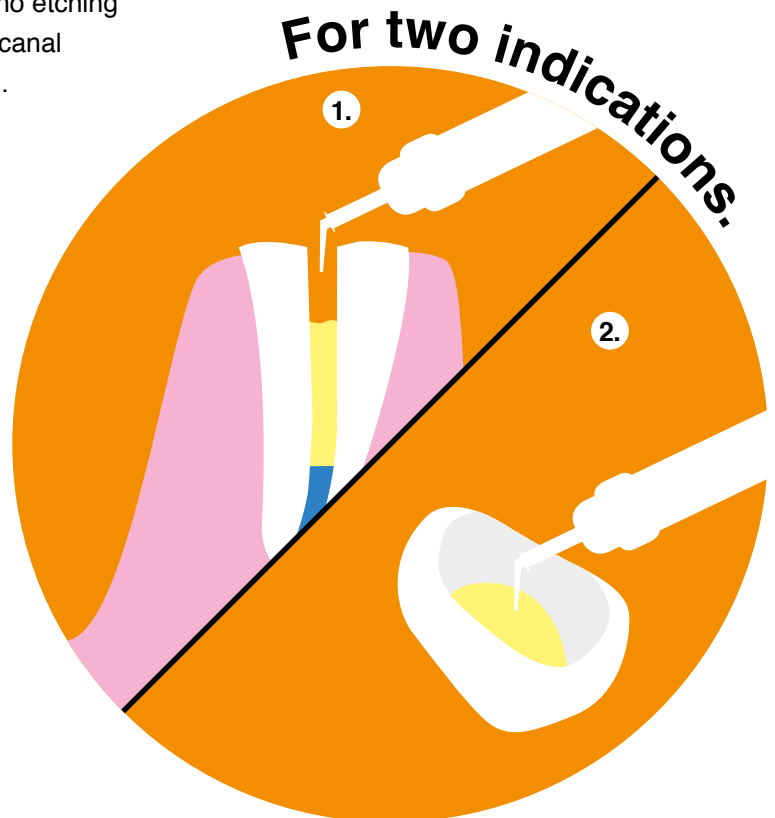

Easy to use and good for time saving.



1. Post cementing

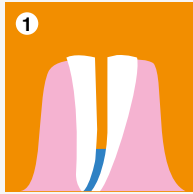

Prepared root canal for post cementing

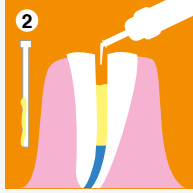

Application of **Harvard LuteCem SE** onto the post and into the prepared root canal

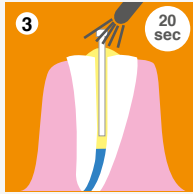

Positioning of the post into the root canal, light curing of the coronal part

2. Crown cementing



Application into the crown



Crown seated and light cured at the cervical edge



Result:
Easy removal of material excess

Physical Properties

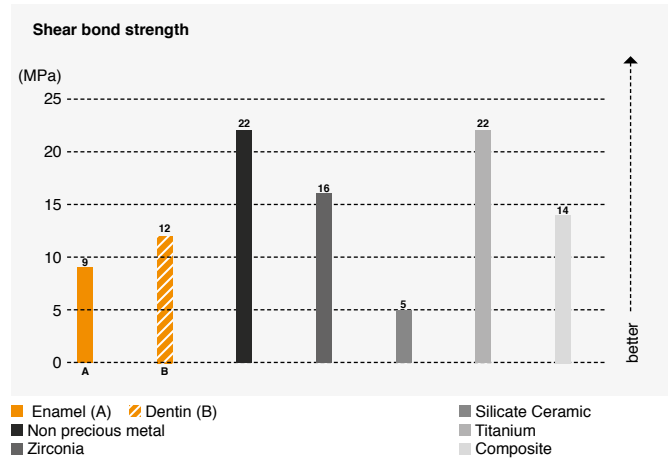

Cumulative fluoride release

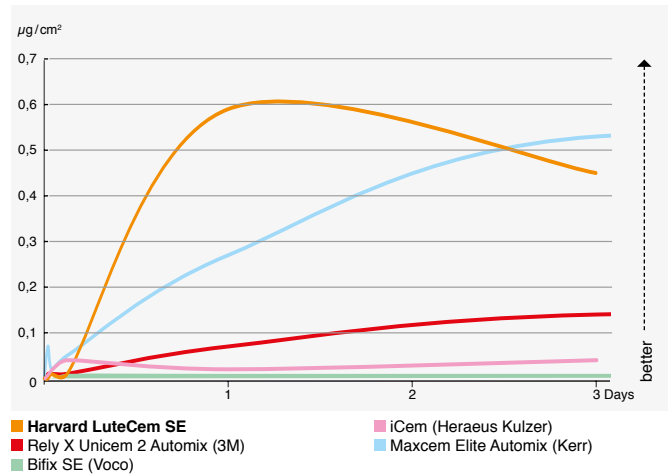

Technical data

Shear bond strength on enamel/dentin	9/12 MPa
Compressive strength	180 MPa
Setting time (self cure)	4:00 min.
Light-curing (optional)	20 sec.

Article information

Order no.	Order no.
Harvard LuteCem SE 5 ml minimix syringe, 10 mixing tips Harvard Mini 4:1/10:1 S-Brown, 5 mixing tips Harvard Mini 4:1/10:1 O-Brown, 5 intra tips long Shade Translucent 7081101 Shade A2 7081105	Harvard Mini 4:1/10:1 S-Brown refill bag with 50 mixing tips 7093050
	Harvard Mini 4:1/10:1 O-Brown refill bag with 50 mixing tips 7091100
	Harvard IntraTips long refill bag with 50 intra tips long 7083620

Liability is excluded for all printing errors and omissions. Before using our Harvard products, the respective directions for use should be noticed in every case. All measurements are internal measurements of Harvard Dental International.

Harvard Distribution Partner.



HARVARD®

Marke und Qualität seit 1892

Harvard Dental International GmbH
Margaretenstr. 2 - 4, 15366 Hoppegarten, Germany
Phone: + 49 (0) 30/99 28 978-0
Fax: + 49 (0) 30/99 28 978-19
info@harvard-dental-international.de